

İLİ : YALOVA
İLÇESİ : MERKEZ
KÖY/MAH. : KADIKÖY
T.C. KADIKÖY

BELEDİYESİ

NOLU UYGULAMA SAHASI

Ö Z E T

C E T V E L İ

K A D A S T R O

İ M A R

Ada/Par	Alan	Kamu.	Y.Terk	D.Girmeyen	Dopal	Dopalma	Dop	İ.Tahsis	AdaNo	Alan
116/46	523.01	-	-	-	523.01	-	95.30	427.71	304	5022.88
116/135	655.00	-	-	-	0.00	655.00	0.00	655.00		
116/136	1535.10	-	-	-	1535.10	-	279.72	1255.38		
304/1	447.35	-	-	-	0.00	447.35	0.00	447.35		
304/2	447.46	-	-	-	0.00	447.46	0.00	447.46		
304/3	447.49	-	-	-	0.00	447.49	0.00	447.49		
304/4	447.59	-	-	-	0.00	447.59	0.00	447.59		
304/5	447.43	-	-	-	0.00	447.43	0.00	447.43		
304/6	447.47	-	-	-	0.00	447.47	0.00	447.47		

K A D A S T R O T O P L A M L A R I

İ M A R

Toplam Pay	Toplam Alan	Top Kamu	Toplam Y.Terk	Toplam D.Girmeyen	Toplam Dopal	Top. Düz. Giren Dopalma	Dop	Toplam Tahsis	Toplam Alan
5397.90	5397.90	0.00	-	0.00	2058.11	3339.79	375.02	5022.88	5022.88

Düzenleme Ortaklık Payı Hesabı

Kamuya Ayrılan Alan= 5397.90 - 5022.88 = 375.02
Düzenleme Ortaklık Payı = 375.02 / 2058.11 = 0.1822157

CHIRAN ALIŞTIRMA
Har. Kad. No: 5475-C
No. Sic. No: 17116/10 Tes. No: 202.1014
Yalova V.D. 722 320 110

GEMİSEYİTUK
Harita Mühendisi

Sefika A. GÜMÜŞ
Fen İşleri Müdürü V

UYGULAMA SAHASI TAHSİS CETVELİ

SAYFA NO: 1

KADASTRO		İMAR ADA NO											K.Par T	
Ada	Par	304												
116	46	427.71												427.71
116	135	655.00												655.00
116	136	1255.38												1255.38
304	1	447.35												447.35
304	2	447.46												447.46
304	3	447.49												447.49
304	4	447.59												447.59
304	5	447.43												447.43
304	6	447.47												447.47
Toplam		5022.88												5022.88

Harita No: 5022.88
Şe. No: 1014

Cemil SELÇUK
Harita Müdürü

Şefika A. GÜMÜŞ
Fen İşleri Müdürü

TOPLAM ALAN : 5397.90	M A L S A W İ P L E R İ A R A Ş T I R M A V E Ö Z E T F O R M U (K A D A S T R O P A R S E L İ N E S I R A L I)	SAYFA NO: 1
TOPLAM PAY : 5397.90		
TOPLAM KAMULAŞTIRMA : 0.00		TOPLAM ADA ALANI : 5022.88
TOP. DÜZENLE. GİRMEYEN: 0.00		O.KATILIM ORANI : 0.0000000
TOP. DÜZENLEMeye GİREN: 5397.90		D.O.PAYI ORANI : 0.1822157

K A D A S T R O							İ M A R				
SNo	Pafta	Ada/Par	Alan/Pay	Hisse	Malik/Baba Adı	Kamu	Dop/İTh	Ada/Par	Alan	Hisse	Pay
1	G22D15B4D	116/46	523.01 523.01	TAM	HALİT AKSOY SABRİ	-	95.30 427.71	304/11	427.71	TAM	427.71
2	G22D15B4D	116/135	655.00 262.00	2 5	FATİH ALBAYRAK OSMAN	-	0.00 262.00	304/10 304/12	634.09 1276.29	25364/63409 836/127629	253.64 8.36
3	G22D15B4D	116/135	655.00 262.00	2 5	YAVUZ ALBAYRAK OSMAN	-	0.00 262.00	304/10 304/12	634.09 1276.29	25364/63409 836/127629	253.64 8.36
4	G22D15B4D	116/135	655.00 131.00	1 5	BETÜL GÖKTUĞ MEHMET RUHİ	-	0.00 131.00	304/10 304/12	634.09 1276.29	12681/63409 419/127629	126.81 4.19
5	G22D15B4D	116/136	1535.10 614.04	2 5	FATİH ALBAYRAK OSMAN	-	111.88 502.16	304/12	1276.29	50216/127629	502.16
6	G22D15B4D	116/136	1535.10 614.04	2 5	YAVUZ ALBAYRAK OSMAN	-	111.89 502.15	304/12	1276.29	50215/127629	502.15
7	G22D15B4D	116/136	1535.10 307.02	1 5	BETÜL GÖKTUĞ MEHMET RUHİ	-	55.95 251.07	304/12	1276.29	25107/127629	251.07
8	G22D15B4D	304/1	447.35 83.87	3 16	SALİM ORAL MEHMET BEŞİR	-	0.00 83.87	304/7	447.35	8387/44735	83.87
9	G22D15B4D	304/1	447.35 83.88	3 16	LEMAN ÜNAL MEHMET BEŞİR	-	0.00 83.88	304/7	447.35	8388/44735	83.88
10	G22D15B4D	304/1	447.35 83.88	3 16	AZİZ ORAL MEHMET BEŞİR	-	0.00 83.88	304/7	447.35	8388/44735	83.88
11	G22D15B4D	304/1	447.35 111.84	1 4	FİKRİYE ORAL OSMAN	-	0.00 111.84	304/7	447.35	11184/44735	111.84
25	G22D15B4D	304/1	447.35 83.88	3 16	MUHİTTİN ORAL MEHMET BEŞİR	-	0.00 83.88	304/7	447.35	8388/44735	83.88
12	G22D15B4D	304/2	447.46 447.46	TAM	MAKSUT ATİK ARİF	-	0.00 447.46	304/8	447.46	TAM	447.46
13	G22D15B4D	304/3	447.49 447.49	TAM	MAKSUT ATİK ARİF	-	0.00 447.49	304/9 304/13	418.43 476.65	TAM 2906/47665	418.43 29.06
14	G22D15B4D	304/4	447.59 447.59	TAM	MAKSUT ATİK ARİF	-	0.00 447.59	304/13	476.65	44759/47665	447.59
15	G22D15B4D	304/5	447.43 83.90	3 16	SALİM ORAL MEHMET BEŞİR	-	0.00 83.90	304/14	447.43	8390/44743	83.90
16	G22D15B4D	304/5	447.43 83.89	3 16	LEMAN ÜNAL MEHMET BEŞİR	-	0.00 83.89	304/14	447.43	8389/44743	83.89

Şefika A. GÜMÜŞ
Fen İşleri Müdürü V.

ÇİFTLİK
No: 51/2
Dip. No: 51/2
S. No: 1711

Cemil
Müdürü

TOPLAM ALAN : 5397.90	M A L S A H İ P L E R İ A R A Ş T I R M A V E Ö Z E T F O R M U (K A D A S T R O P A R S E L İ N E S I R A L I)	SAYFA NO: 2
TOPLAM PAY : 5397.90		
TOPLAM KAMULAŞTIRMA : 0.00		TOPLAM ADA ALANI : 5022.88
TOP. DÜZENLE. GİRMEYEN: 0.00		O.KATILIM ORANI : 0.0000000
TOP. DÜZENLEMeye GİREN: 5397.90		D.O.PAYI ORANI : 0.1822157

K A D A S T R O							İ M A R				
SNo	Pafta	Ada/Par	Alan/Pay	Hisse	Malik/Baba Adı	Kamu	Dop/İTh	Ada/Par	Alan	Hisse	Pay
17	G22D15B4D	304/5	447.43 83.89	3 16	AZİZ ORAL MEHMET BEŞİR	-	0.00 83.89	304/14	447.43	8389/44743	83.89
18	G22D15B4D	304/5	447.43 83.89	3 16	MUHİTTİN ORAL MEHMET BEŞİR	-	0.00 83.89	304/14	447.43	8389/44743	83.89
19	G22D15B4D	304/5	447.43 111.86	1 4	FİKRİYE ORAL OSMAN	-	0.00 111.86	304/14	447.43	11186/44743	111.86
20	G22D15B4D	304/6	447.47 83.90	3 16	SALİM ORAL MEHMET BEŞİR	-	0.00 83.90	304/15	447.47	8390/44747	83.90
21	G22D15B4D	304/6	447.47 83.90	3 16	LEMEN ÜNAL MEHMET BEŞİR	-	0.00 83.90	304/15	447.47	8390/44747	83.90
22	G22D15B4D	304/6	447.47 83.90	3 16	AZİZ ORAL MEHMET BEŞİR	-	0.00 83.90	304/15	447.47	8390/44747	83.90
23	G22D15B4D	304/6	447.47 83.90	3 16	MUHİTTİN ORAL MEHMET BEŞİR	-	0.00 83.90	304/15	447.47	8390/44747	83.90
24	G22D15B4D	304/6	447.47 111.87	1 4	FİKRİYE ORAL OSMAN	-	0.00 111.87	304/15	447.47	11187/44747	111.87

ÖZEL
Dip. No: 5114
Tic. Sic. No: 21014
Yalova V.D. 733 312

Cemil SEZGİN
Harita Müdürlüğü

Şefika A. GÜMÜŞ
Fen İşleri Müdürü

TOPLAM ALAN : 5397.90
TOPLAM PAY : 5397.90
TOPLAM KAMULAŞTIRMA : 0.00
TOP. DÜZENLE. GİRMEYEN: 0.00
TOP. DÜZENLEMeye GİREN: 5397.90

TESCİLE ESAS
DAĞITIM CETVELİ
(İMAR PARSELİNE SIRALI)

SAYFA NO: 1

TOPLAM ADA ALANI : 5022.88
O.KATILIM ORANI : 0.0000000
D.O.PAYI ORANI : 0.1822157

K A D A S T R O							İ M A R				
SNo	Pafta	Ada/Par	Alan	Hisse	Malik/Baba Adı	Kamu	Dop/İTh	Ada/Par	Alan	Hisse	Pay
8	G22D15B4D	304/1	447.35	3/16	SALİM ORAL	-	0.00	304/7	447.35	3/16	83.87
				83.87	MEHMET BEŞİR		83.87				
9		304/1	447.35	3/16	LEMAN ÜNAL	-	0.00			3/16	83.88
				83.88	MEHMET BEŞİR		83.88				
10		304/1	447.35	3/16	AZİZ ORAL	-	0.00			3/16	83.88
				83.88	MEHMET BEŞİR		83.88				
11		304/1	447.35	1/4	FİKRİYE ORAL	-	0.00			1/4	111.84
				111.84	OSMAN		111.84				
25		304/1	447.35	3/16	MUHİTTİN ORAL	-	0.00			3/16	83.88
				83.88	MEHMET BEŞİR		83.88				
12	G22D15B4D	304/2	447.46	TAM	MAKSUT ATİK	-	0.00	304/8	447.46	TAM	447.46
				447.46	ARİF		447.46				
13	G22D15B4D	304/3	447.49	TAM	MAKSUT ATİK	-	0.00	304/9	418.43	TAM	418.43
				447.49	ARİF		447.49				
2	G22D15B4D	116/135	655.00	2/5	FATİH ALBAYRAK	-	0.00	304/10	634.09	2/5	253.64
				262.00	OSMAN		262.00				
3		116/135	655.00	2/5	YAVUZ ALBAYRAK	-	0.00			2/5	253.64
				262.00	OSMAN		262.00				
4		116/135	655.00	1/5	BETÜL GÖKTUĞ	-	0.00			1/5	126.81
				131.00	MEHMET RUHİ		131.00				
1	G22D15B4D	116/46	523.01	TAM	HALİT AKSOY	-	95.30	304/11	427.71	TAM	427.71
				523.01	SABRİ		427.71				
2	G22D15B4D	116/135	655.00	2/5	FATİH ALBAYRAK	-	0.00	304/12	1276.29	836/127629	8.36
				262.00	OSMAN		262.00				
3		116/135	655.00	2/5	YAVUZ ALBAYRAK	-	0.00			836/127629	8.36
				262.00	OSMAN		262.00				
4		116/135	655.00	1/5	BETÜL GÖKTUĞ	-	0.00			419/127629	4.19
				131.00	MEHMET RUHİ		131.00				
5		116/136	1535.10	2/5	FATİH ALBAYRAK	-	111.88			50216/127629	502.16
				614.04	OSMAN		502.16				
6		116/136	1535.10	2/5	YAVUZ ALBAYRAK	-	111.89			50215/127629	502.15
				614.04	OSMAN		502.15				
7		116/136	1535.10	1/5	BETÜL GÖKTUĞ	-	55.95			25107/127629	251.07
				307.02	MEHMET RUHİ		251.07				
13	G22D15B4D	304/3	447.49	TAM	MAKSUT ATİK	-	0.00	304/13	476.65	2906/47665	29.06
				447.49	ARİF		447.49				
14		304/4	447.59	TAM	MAKSUT ATİK	-	0.00			44759/47665	447.59
				447.59	ARİF		447.59				
15	G22D15B4D	304/5	447.43	3/16	SALİM ORAL	-	0.00	304/14	447.43	3/16	83.90
				83.90	MEHMET BEŞİR		83.90				
16		304/5	447.43	3/16	LEMAN ÜNAL	-	0.00			3/16	83.89
				83.89	MEHMET BEŞİR		83.89				
17		304/5	447.43	3/16	AZİZ ORAL	-	0.00			3/16	83.89

K A D A S T R O						İ M A R					
SNo	Pafta	Ada/Par	Alan	Hisse	Malik/Baba Adı	Kamu	Dop/İTh	Ada/Par	Alan	Hisse	Pay
18		304/5	447.43	83.89 3/16	MEHMET BEŞİR MUHİTTİN ORAL	-	83.89 0.00			3/16	83.89
19		304/5	447.43	83.89 1/4 111.86	MEHMET BEŞİR FİKRİYE ORAL OSMAN	-	83.89 0.00 111.86			1/4	111.86
20	G22D15B4D	304/6	447.47	3/16 83.90	SALİM ORAL MEHMET BEŞİR	-	0.00 83.90	304/15	447.47	3/16	83.90
21		304/6	447.47	3/16 83.90	LEMEN ÜNAL MEHMET BEŞİR	-	0.00 83.90			3/16	83.90
22		304/6	447.47	3/16 83.90	AZİZ ORAL MEHMET BEŞİR	-	0.00 83.90			3/16	83.90
23		304/6	447.47	3/16 83.90	MUHİTTİN ORAL MEHMET BEŞİR	-	0.00 83.90			3/16	83.90
24		304/6	447.47	1/4 111.87	FİKRİYE ORAL OSMAN	-	0.00 111.87			1/4	111.87

CİHAN
 Har. K...
 Dip. No: 5473-C
 No. Sic. No: 17...
 Yaka V.D. 202 320...

Cemil...
 Harita...
 Harita...

Sefika A. GÜMÜS
 Fen İşleri Müdürü V.
 7.

İLİ : YALOVA
İLÇESİ : MERKEZ
KÖYÜ : KADIKÖY
PAFTA : G22D15B4D
ADA/PARSEL : 116/46+135+136
304/1+2+3+4++6

PARSELASYON PLANI



4 499 400

4 499 300

434 700

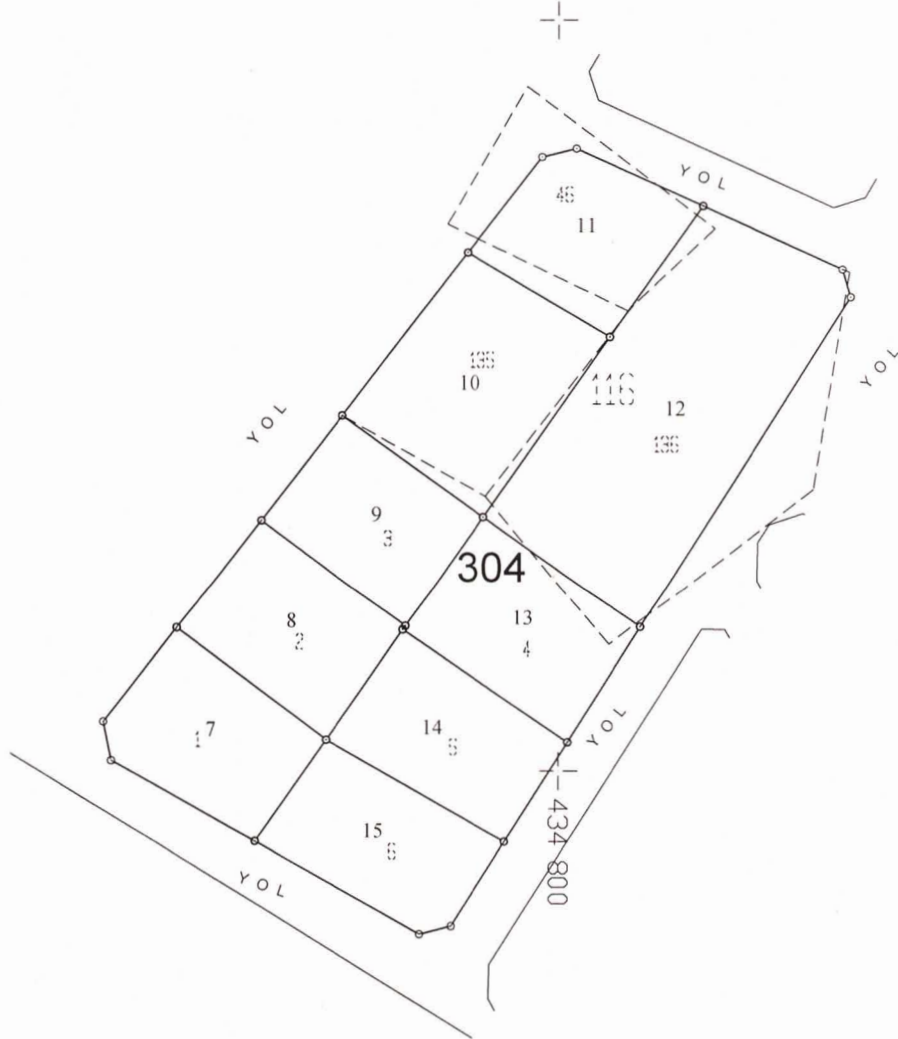

1/1000

	DÜZENLEYEN	BELEDİYE / ÖZEL İDARE	
		KONTROL EDEN	ONAYLAYAN
ADI SOYADI	CİHAN ALTUN Har. Kad. Müh. Dip. No: 5473-Ode Sic. No: 12 Tic. Sic. No: 17138/Şim. Tes. No: 2.02.101- Yalova V.D. 300 795	Cemil SELÇUK Har. Müh. Uzmanı	Şefika A. GÜMÜŞ Fen İşleri Müdür-V.
TARİH			
İMZA			